

Proposed Works | North Aisle | Servery

4nr pews and associated platform floor removed. Area of concrete slabs to the west removed. New blue Lias floor on a new solid limecrete subfloor. Lias slabs to be random sizes with 100mm wide margin around perimeter of new floor area.

Proposed Works | North Transept | Office

Existing floor boards carefully lifted and new floor joist structure inserted. Including new wall plates and repairs to dwarf walls.

© This Drawing is the copyright of benjamin + beauchamp architects ltd.
All dimensions to be checked on site by contractor and not scaled from this drawing.
benjamin + beauchamp architects ltd accept no liability for any expense, loss or damage of whatsoever nature and however arising from any variation made to this drawing or in the execution of the work to which it relates, which has not been referred to them and their approval obtained.
P:\Tiverton - St Peter - 0552\Drawings, Photos & Graphics\B2 Drawings\Drawing board\4.WORKING DRAWINGS\0552.WD.010 Proposed Floor Finishes.dwg

Proposed Works | Dais

8nr pews and associated platform floor removed. Pew frontals relocated.

Stone paving across central area of raised step - dais - carefully lifted and set aside for reuse.

New dais constructed as per latest architects drawing and finished with new blue Lias stone floor. Lias slabs to be regular coursed, of random sizes, with 100mm wide margin around perimeter of the new area of floor.

Area of removed timber platform to receive new blue Lias floor on solid limecrete subfloor construction. Lias slabs to be regular coursed, of random sizes, with 100mm wide margin around perimeter of the new area of floor.

West End

8nr pews and associated platform floor removed. Area of concrete slabs to the west removed. New blue Lias floor on a new solid limecrete subfloor inserted. Lias slabs to be random sizes with 100mm wide margin around perimeter of new floor area.

Children's Area and Entrance

Assorted pews and furniture removed. Areas of concrete slabs removed. New blue Lias floor on a new solid limecrete subfloor inserted. Lias slabs to be random sizes with 100-300mm wide margin around perimeter of new floor area.

Proposed Works | Font

Box pew and existing stone floor finish carefully removed. Length of redundant heating pipe fixed across Greenway Chapel screen, capped, cut and disposed of.

New setting for the relocated font to be formed from blue Lias slabs on a solid limecrete subfloor construction. Lias slabs to be regular coursed, of random sizes, with 100-300mm wide margin to form new floor design.

Existing stone paving to east and west ends of new floor retained.

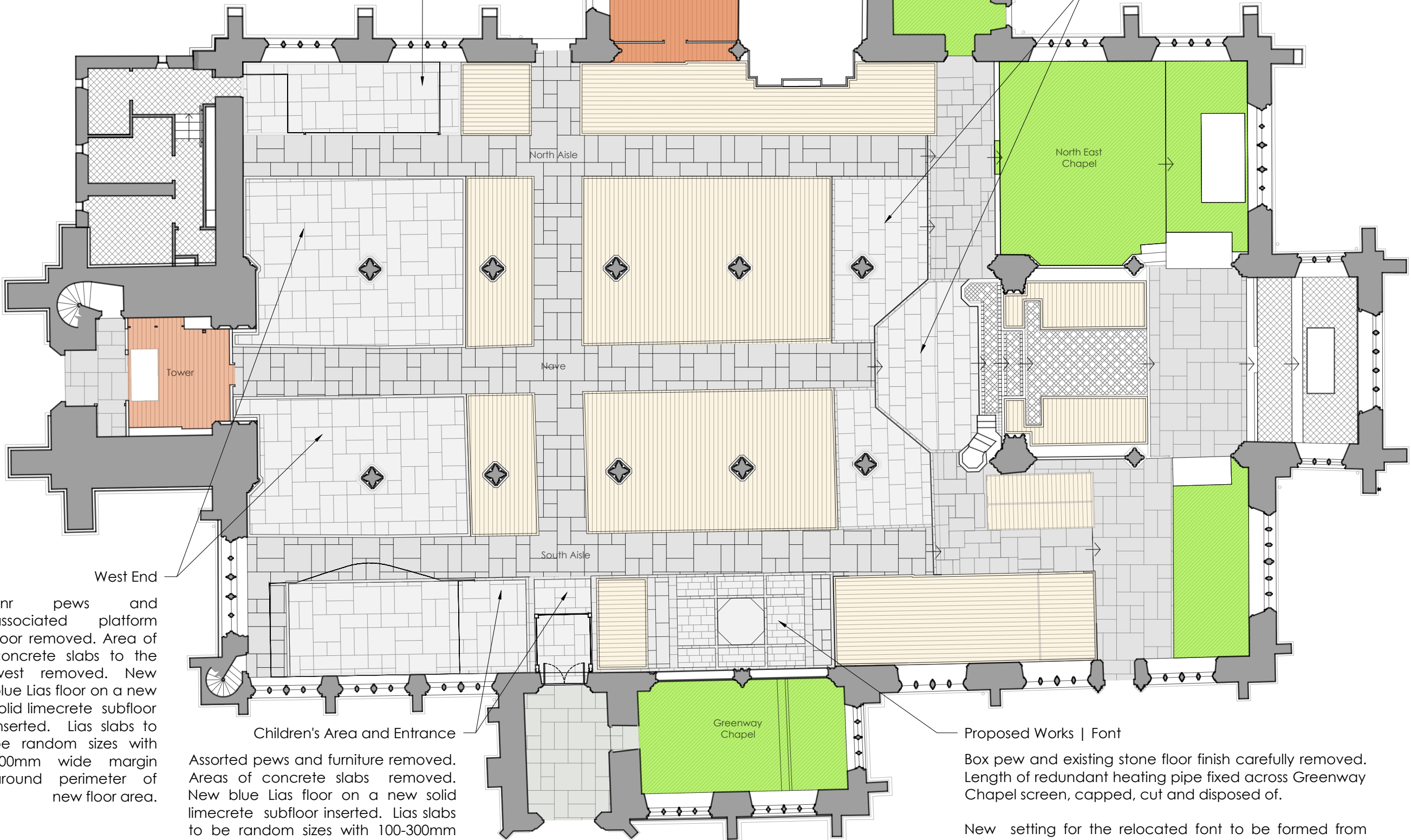

B	30/04/2020	IMV	Plan updated to include pews to the east of the glazed entrance lobby.
A	29/04/2020	IMV	Plan and notes updated to accord with DAC comments re: Greenway chapel.
Revision	Date	Initials	Notes
Project			

TIVERTON
St Peter

Stage
FOR APPROVAL

FOR APPROVAL

benjamin + beauchamp
architecture design conservation
the borough studios, the borough,
wedmore, somerset BS28 4EB
T 01934 713313 F 01934 713314

Drawn By: MV Date: 02/01/20 Scale: N.T.S.

Drawing No. 0552.WD.010 B

Floor Finishes Plan | As Proposed